

MMDA 'C' / PP NO. 1
 C.N. 09/100/15/10
 PART II
 15/2/13

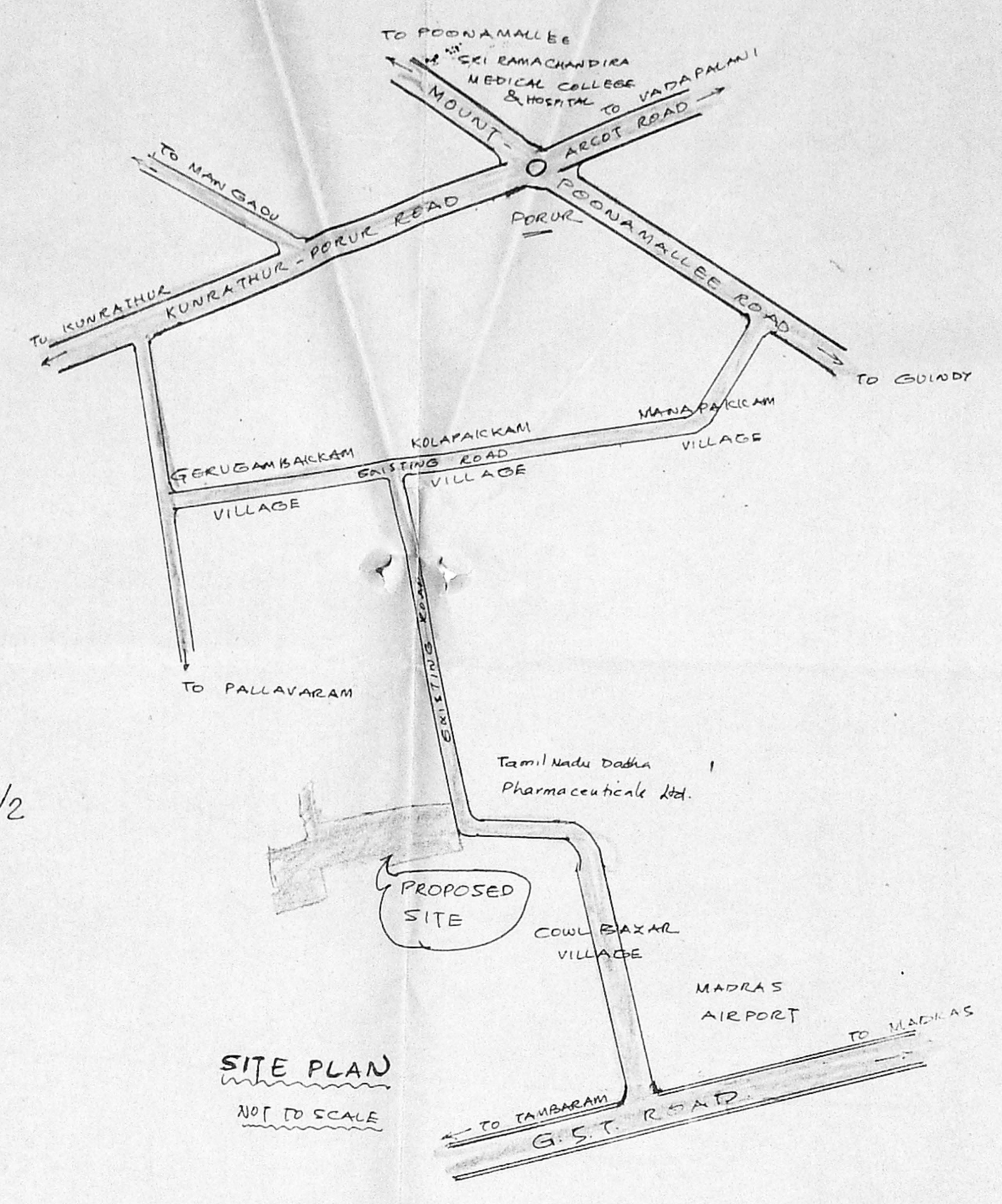
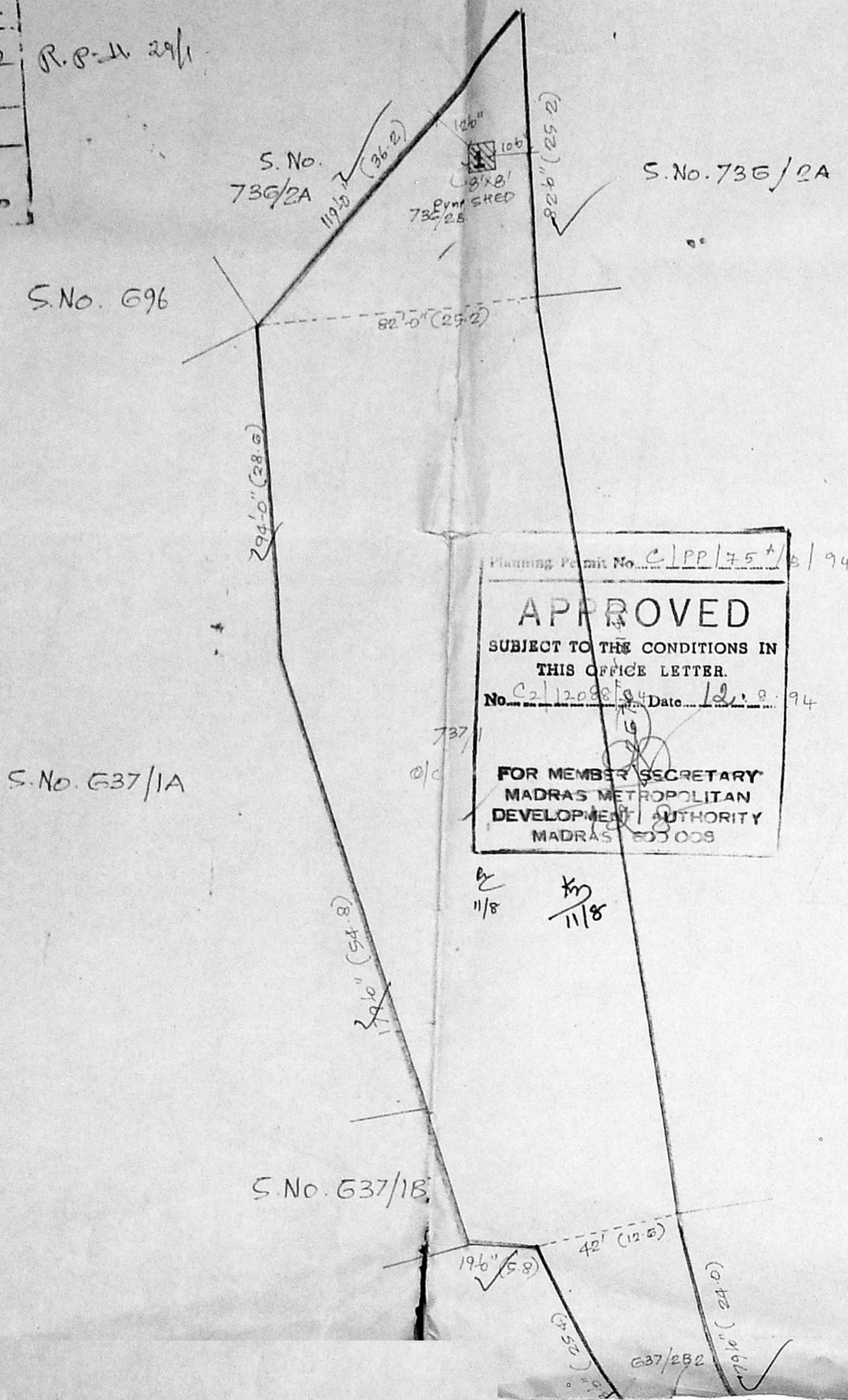

SITE PLAN SHOWING THE EXISTING BUILDINGS OF M/S. TAMILNADU DADHA PHARMACEUTICALS LIMITED IN S.No. 636/3B, 637/2B2, 736/2B, 737/1, 738/1B, 739/2A & 740/1 OF GERUGAMBAKKAM VILLAGE, SRIPERUMBUDUR TALUK, CHENGALPATTU - MGR DISTRICT.

SCALE : 33 FEET TO AN INCH.

ASOKA BRICK WORKS.

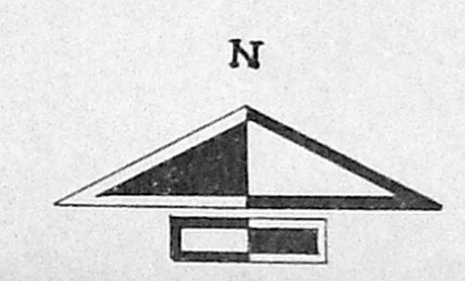

S.No. 738/1A

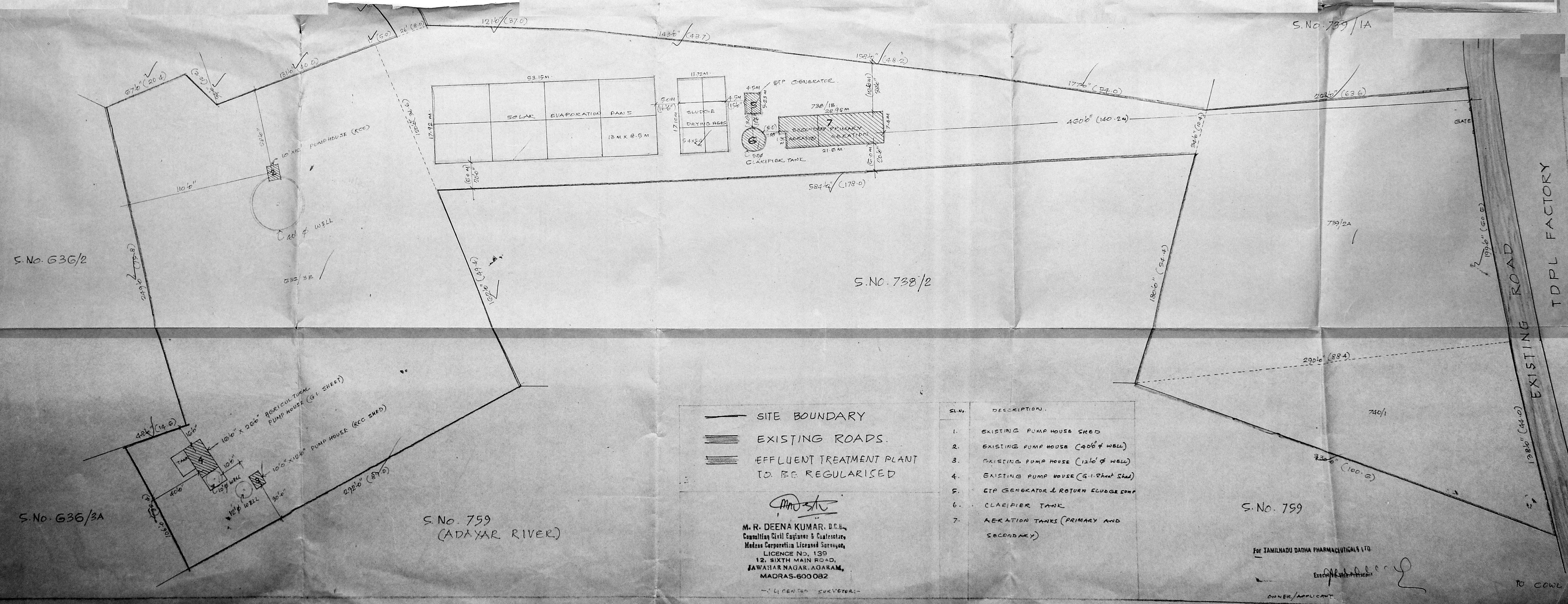

S.N.	DESCRIPTION
1.	EXISTING PUMP HOUSE SHED
2.	EXISTING PUMP HOUSE (400' WELL)
3.	EXISTING PUMP HOUSE (120' WELL)
4.	EXISTING PUMP HOUSE (54' SHED SHED)
5.	GTP GENERATOR & RETURN SLUDGE COMP.
6.	CLARIFIER TANK
7.	AERATION TANKS (PRIMARY AND SECONDARY)

M. R. DEENA KUMAR, D.C.E.,
 Consulting Civil Engineer & Consultant
 Madras Corporation Licensed Surveyor,
 LICENCE NO. 139
 12, SIXTH MAIN ROAD,
 JAWAHAR NAGAR, AGARAM,
 MADRAS-600082

For TAMILNADU DADHA PHARMACEUTICALS LTD.
 OWNER/APPLICANT

